

EXCESS 11

NN2 (2024)



Yacht Real • Ag. Triados 33 • 153 43 Ag. Paraskevi • Greece

Phone: +30 6977 202170

E-mail: info@yachtreal.com

Web: www.yachtreal.com

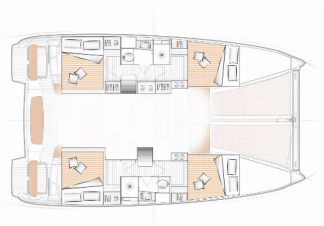

Yacht Base	Marina Tehnomont Veruda, Pula, Croatia
Yacht ID	7523
Yacht Brands	Excess
Yacht Name	NN2
Production Year	2024
Length	37 Ft
Cabins	4 + 2
Berths	8 + 2
Max Persons	10
WC/Shower	2

DECK: Anchor with chain, Anchor with rope , Bilge pump - Mechanic, Bimini top, Boat hook, Bosun's chair (Safe seat) (boatswain's chair), Cockpit fridge, Cockpit table, Cockpit/stern, outside shower, Dinghy, Dinghy hydraulic lifting system, Electric anchor windlass, Fenders, Gangway, Main anchor, Mooring ropes , Sprayhood, Water hose

ENTERTAINMENT: Indoor speakers, Outdoor speakers, TV

GALLEY: Gas bottles, Hot water, Kitchen utensils (Galley equipment, cutlery)

INTERIOR: Barometer, Clock

NAVIGATION: Autopilot, Binoculars, Compass, GPS chart plotter - cockpit, Hand bearing compass, Navigation (Nautical) charts and nautical guide , Radar, Tridata, Wind instrument/Anemometer

SAFETY: Distress flare box, Fire extinguisher , First aid kit , Fog horn, Life belts (Safety harness), VHF radio

SAILS: Electric mainsail windlass, Electric winch, Lazy bag

YACHT ELECTRICS: 220V socket, Battery charger , Bilge pump - Electric, DC plugs 12V , Service batteries, Shore connection 220 V, Solar panels, Watermaker - desalinator

PRICE AND AVAILABILITY

Excess 11 NN2 (2024)



21.09. – 28.09.2024 4.257 € 5.676 €	28.09. – 05.10.2024 2.904 € 3.872 €	05.10. – 12.10.2024 2.904 € 3.872 €	12.10. – 19.10.2024 2.904 € 3.872 €
19.10. – 26.10.2024 2.904 € 3.872 €	26.10. – 02.11.2024 2.904 € 3.872 €	02.11. – 31.12.2024 Not available	31.12. – 29.03.2025 Not available
29.03. – 05.04.2025 3.485 € 3.872 €	05.04. – 12.04.2025 3.485 € 3.872 €	12.04. – 19.04.2025 3.485 € 3.872 €	19.04. – 26.04.2025 3.485 € 3.872 €
26.04. – 03.05.2025 3.485 € 3.872 €			

PRICE AND AVAILABILITY

Excess 11 NN2 (2024)



03.05. – 10.05.2025 3.485 € 3.872 €	10.05. – 17.05.2025 3.485 € 3.872 €	17.05. – 24.05.2025 3.485 € 3.872 €	24.05. – 31.05.2025 3.485 € 3.872 €
31.05. – 07.06.2025 3.890 € 4.322 €	07.06. – 14.06.2025 Not available	14.06. – 21.06.2025 3.890 € 4.322 €	21.06. – 28.06.2025 5.484 € 6.452 €
28.06. – 05.07.2025 5.484 € 6.452 €	05.07. – 12.07.2025 Not available	12.07. – 19.07.2025 5.484 € 6.452 €	19.07. – 26.07.2025 5.484 € 6.452 €
26.07. – 02.08.2025 5.849 € 6.881 €	02.08. – 09.08.2025 5.849 € 6.881 €	09.08. – 16.08.2025 5.849 € 6.881 €	16.08. – 23.08.2025 5.849 € 6.881 €
23.08. – 30.08.2025 5.108 € 5.676 €	30.08. – 06.09.2025 5.108 € 5.676 €	06.09. – 13.09.2025 5.108 € 5.676 €	13.09. – 20.09.2025 5.108 € 5.676 €
20.09. – 27.09.2025 5.108 € 5.676 €	27.09. – 04.10.2025 3.485 € 3.872 €	04.10. – 11.10.2025 3.485 € 3.872 €	11.10. – 18.10.2025 3.485 € 3.872 €
18.10. – 25.10.2025 3.485 € 3.872 €	25.10. – 01.11.2025 3.485 € 3.872 €	01.11. – 08.11.2025 3.485 € 3.872 €	08.11. – 15.11.2025 3.485 € 3.872 €
15.11. – 22.11.2025 3.485 € 3.872 €	22.11. – 29.11.2025 3.485 € 3.872 €	29.11. – 06.12.2025 3.485 € 3.872 €	06.12. – 13.12.2025 3.485 € 3.872 €
13.12. – 20.12.2025 3.485 € 3.872 €	20.12. – 27.12.2025 3.485 € 3.872 €		