

# FOUNTAIN PAJOT SAONA 47 QUINTET

Eclipse (2020)



Yacht Real • Ag. Triados 33 • 153 43 Ag. Paraskevi • Greece

Phone: +30 6977 202170

E-mail: info@yachtreal.com

Web: www.yachtreal.com

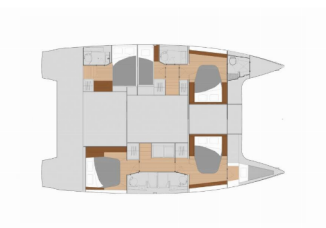

|                        |                               |
|------------------------|-------------------------------|
| <b>Yacht Base</b>      | Athens, Alimos Marina, Greece |
| <b>Yacht ID</b>        | 4159                          |
| <b>Yacht Brands</b>    | Fountaine Pajot               |
| <b>Yacht Name</b>      | Eclipsea                      |
| <b>Production Year</b> | 2020                          |
| <b>Length</b>          | 46 Ft                         |
| <b>Cabins</b>          | 5 + 1                         |
| <b>Berths</b>          | 10 + 2                        |
| <b>WC/Shower</b>       | 5 + 1                         |

**DECK:** Anchor winch remote control, Bimini top, Black ball, Boat hook, Cockpit cushions, Cockpit table, Cockpit/stern, outside shower, Dinghy with outboard engine, Hydraulic gangway, Main anchor, Outboard engine, Spare anchor (Reserve, Auxiliary anchor), Sprayhood, Swimming ladder, Water hose, Winch handles

**ENTERTAINMENT:** Outdoor speakers, Radio CD player, USB, Bluetooth, Snorkeling equipment, TV

**GALLEY:** Gas bottles, Gas cookers, Kitchen utensils (Galley equipment, cutlery), Refrigerator

**INTERIOR:** Barometer, Bedlinen and towels, Blankets, Electric toilet, Pillows, Yacht documents

**NAVIGATION:** Autopilot, Binoculars, GPS chart plotter, Hand bearing compass, Log, Speed, Depth- echo sounder, Nautical charts, Wind instrument/Anemometer

**SAFETY:** Distress flare box, Emergency tiller, EPIRB- Distress radio beacons, Fire extinguisher, First aid kit, Fog horn, Horseshoe lifebuoy, Life belts (Safety harness), Life jackets, Liferaft, Torch, VHF radio

**SAILS:** Lazy bag, Lazy jacks

**YACHT ELECTRICS:** 220V socket, Air Conditioning, Battery charger, Generator, Inverter, Solar panels, Watermaker - desalinator

## PRICE AND AVAILABILITY

Fountaine Pajot Saona 47 Quintet Eclipsea (2020)



|   |   |   |   |
|---|---|---|---|
| <b>19.10. – 26.10.2024</b><br>3.315 € 5.100 € | <b>26.10. – 02.11.2024</b><br>Not available   | <b>02.11. – 09.11.2024</b><br>3.315 € 5.100 € | <b>09.11. – 31.12.2024</b><br>Not available   |
| <b>04.01. – 11.01.2025</b><br>4.410 € 4.900 € | <b>11.01. – 18.01.2025</b><br>4.410 € 4.900 € | <b>18.01. – 25.01.2025</b><br>4.410 € 4.900 € | <b>25.01. – 01.02.2025</b><br>4.410 € 4.900 € |
| <b>01.02. – 08.02.2025</b><br>4.410 € 4.900 € | <b>08.02. – 15.02.2025</b><br>4.410 € 4.900 € | <b>15.02. – 22.02.2025</b><br>4.410 € 4.900 € | <b>22.02. – 01.03.2025</b><br>4.410 € 4.900 € |
| <b>01.03. – 08.03.2025</b><br>4.410 € 4.900 € | <b>08.03. – 15.03.2025</b><br>4.410 € 4.900 € | <b>15.03. – 22.03.2025</b><br>4.410 € 4.900 € | <b>22.03. – 29.03.2025</b><br>4.410 € 4.900 € |
| <b>29.03. – 05.04.2025</b><br>4.410 € 4.900 € | <b>05.04. – 12.04.2025</b><br>3.430 € 4.900 € | <b>12.04. – 19.04.2025</b><br>3.430 € 4.900 € | <b>19.04. – 26.04.2025</b><br>3.430 € 4.900 € |
| <b>26.04. – 03.05.2025</b><br>4.830 € 6.900 € | <b>03.05. – 10.05.2025</b><br>5.175 € 6.900 € | <b>10.05. – 17.05.2025</b><br>5.175 € 6.900 € | <b>17.05. – 24.05.2025</b><br>5.175 € 6.900 € |
| <b>24.05. – 31.05.2025</b><br>Not available   | <b>31.05. – 07.06.2025</b><br>Not available   |   |   |

## PRICE AND AVAILABILITY

Fountaine Pajot Saona 47 Quintet Eclipsea (2020)



|  |  |  |   |
|--|--|--|---|
| <b>07.06. – 14.06.2025</b><br>Not available    | <b>14.06. – 21.06.2025</b><br>8.010 € 8.900€   | <b>21.06. – 28.06.2025</b><br>9.450 € 10.500€  | <b>28.06. – 05.07.2025</b><br>9.450 € 10.500€ |
| <b>05.07. – 12.07.2025</b><br>9.450 € 10.500€  | <b>12.07. – 19.07.2025</b><br>9.450 € 10.500€  | <b>19.07. – 26.07.2025</b><br>Not available    | <b>26.07. – 02.08.2025</b><br>On option       |
| <b>02.08. – 09.08.2025</b><br>11.430 € 12.700€ | <b>09.08. – 16.08.2025</b><br>11.430 € 12.700€ | <b>16.08. – 23.08.2025</b><br>11.430 € 12.700€ | <b>23.08. – 30.08.2025</b><br>9.450 € 10.500€ |
| <b>30.08. – 06.09.2025</b><br>9.450 € 10.500€  | <b>06.09. – 13.09.2025</b><br>9.450 € 10.500€  | <b>13.09. – 04.10.2025</b><br>Not available    | <b>04.10. – 11.10.2025</b><br>6.210 € 6.900€  |
| <b>11.10. – 18.10.2025</b><br>4.590 € 5.100€   | <b>18.10. – 25.10.2025</b><br>4.590 € 5.100€   | <b>25.10. – 01.11.2025</b><br>4.590 € 5.100€   | <b>01.11. – 08.11.2025</b><br>4.590 € 5.100€  |
| <b>08.11. – 15.11.2025</b><br>4.590 € 5.100€   | <b>15.11. – 22.11.2025</b><br>4.590 € 5.100€   | <b>22.11. – 29.11.2025</b><br>4.590 € 5.100€   | <b>29.11. – 06.12.2025</b><br>4.590 € 5.100€  |
| <b>06.12. – 13.12.2025</b><br>4.590 € 5.100€   | <b>13.12. – 20.12.2025</b><br>4.590 € 5.100€   | <b>20.12. – 27.12.2025</b><br>4.590 € 5.100€   |   |