

LAGOON 400 S2

Lady Dom (2015)



Yacht Real • ☰ ☰ ☰ ☰ 33 • 153 43 ☰ ☰ ☰ ☰ • ☰ ☰ ☰ ☰

☰ ☰ ☰ ☰ 30 69 77 202170

☰ ☰ ☰ ☰ info@yachtreal.com

Web: www.yachtreal.com

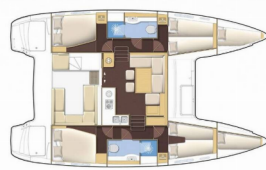

☰ ☰ ☰ ☰	Nikiti, Greece
☰ ☰ ☰ ☰ ID	286
☰ ☰ ☰ ☰	Lagoon
☰ ☰ ☰ ☰	Lady Dom
☰ ☰ ☰ ☰	2015
☰ ☰ ☰	39 Ft
☰ ☰ ☰ ☰	4 + 2
☰ ☰ ☰ ☰	8 + 2 + 2
☰ ☰ ☰ ☰ ☰ ☰ ☰ ☰	10
☰ ☰ ☰ ☰ / ☰ ☰ ☰	2

DECK: Cockpit/stern, outside shower, Dinghy, Electric anchor windlass, Gangway, Hard Top Bimini, Main anchor, Outboard engine, Sprayhood, Swimming ladder

ENTERTAINMENT: Mobile phone, Radio with USB

GALLEY: Hot water, Kitchen utensils (Galley equipment, cutlery), Microwave, Oven, Refrigerator

INTERIOR: Electric toilet

NAVIGATION: AIS, Autopilot, Compass, Echosounder/Depthsounder, GPS, GPS chart plotter - cockpit, Log, Wind instrument/Anemometer, Windex

SAFETY: Black Water Tank, EPIRB-Distress radio beacons, Safety equipment, VHF radio

YACHT ELECTRICS: Batteries, Inverter, Plug 220V, 12 V, Solar panels

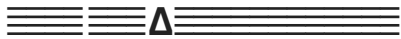



Lagoon 400 S2 Lady Dom (2015)



YACHTREAL

HOLIDAYS AT SEA

04.01. – 11.01.2025 4.140 €	11.01. – 18.01.2025 4.140 €	18.01. – 25.01.2025 4.140 €	25.01. – 01.02.2025 4.140 €
01.02. – 08.02.2025 4.140 €	08.02. – 15.02.2025 4.140 €	15.02. – 22.02.2025 4.140 €	22.02. – 01.03.2025 4.140 €
01.03. – 08.03.2025 4.140 €	08.03. – 15.03.2025 4.140 €	15.03. – 22.03.2025 4.140 €	22.03. – 29.03.2025 4.140 €
29.03. – 05.04.2025 4.140 €	05.04. – 12.04.2025 4.140 €	12.04. – 19.04.2025 4.140 €	19.04. – 26.04.2025 4.140 €
26.04. – 03.05.2025 4.140 €	03.05. – 10.05.2025 5.190 €	10.05. – 17.05.2025 5.190 €	17.05. – 24.05.2025 
24.05. – 31.05.2025 	31.05. – 07.06.2025 5.190 €	07.06. – 14.06.2025 5.190 €	14.06. – 21.06.2025 
21.06. – 28.06.2025 6.550 €	28.06. – 05.07.2025 6.550 €	05.07. – 12.07.2025 6.550 €	12.07. – 19.07.2025 
19.07. – 26.07.2025 7.750 €	26.07. – 02.08.2025 7.750 €		

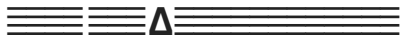

Lagoon 400 S2 Lady Dom (2015)



YACHTREAL
HOLIDAYS AT SEA

02.08. – 09.08.2025 7.750 €	09.08. – 16.08.2025 7.750 €	16.08. – 23.08.2025 6.550 €	23.08. – 30.08.2025 
30.08. – 06.09.2025 6.550 €	06.09. – 13.09.2025 5.190 €	13.09. – 20.09.2025 5.190 €	20.09. – 18.10.2025 
18.10. – 25.10.2025 4.140 €	25.10. – 01.11.2025 4.140 €	01.11. – 08.11.2025 4.140 €	08.11. – 15.11.2025 4.140 €
15.11. – 22.11.2025 4.140 €	22.11. – 29.11.2025 4.140 €	29.11. – 06.12.2025 4.140 €	06.12. – 13.12.2025 4.140 €
13.12. – 20.12.2025 4.140 €	20.12. – 27.12.2025 4.140 €		